

Name:

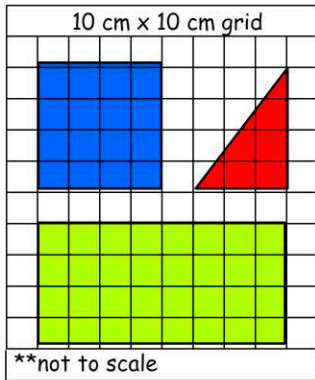

1. The area of the square is:

- 8 cm<sup>2</sup>       12 cm<sup>2</sup>  
 16 cm<sup>2</sup>       18 cm<sup>2</sup>

2. Calculate the area of the rectangle.  cm<sup>2</sup>

3. The area of the triangle is about:

- 4 cm<sup>2</sup>       8 cm<sup>2</sup>  
 6 cm<sup>2</sup>       10 cm<sup>2</sup>

4. Which is true?

- The area of the triangle is half the area of the square.  
 The area of the square is half the area of the rectangle.  
 Four triangles have the same area as the rectangle.

5. If two triangles were placed side by side, what would the combined area be?



- 18 cm<sup>2</sup>       10 cm<sup>2</sup>  
 16 cm<sup>2</sup>       12 cm<sup>2</sup>

### Doll's House Plan

\*\*not to scale

= 1 cm<sup>2</sup>

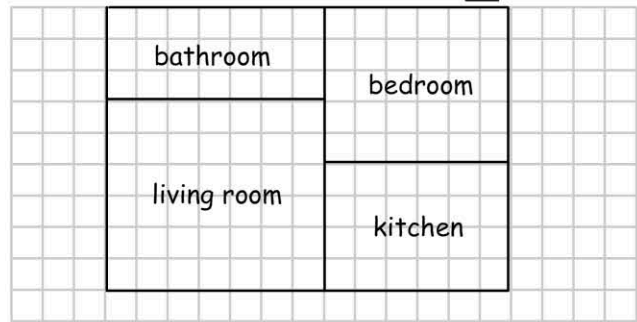

6. Which has the greatest area?

- bedroom       kitchen  
 living room       bathroom

7. The area of the kitchen is 24cm<sup>2</sup>. What's the area of the bedroom?

- 24 cm<sup>2</sup>       30 cm<sup>2</sup>  
 28 cm<sup>2</sup>       36 cm<sup>2</sup>

8. Which room has an area that is half the area of the living room?

- bedroom       kitchen  
 living room       bathroom

9. Difference, in area, between the bathroom and the living room.

cm<sup>2</sup>

10. Difference, in area, between the kitchen and the bedroom.

cm<sup>2</sup>